



1. Remove two (2) existing bolts from opposite corners on the Smart IR sensor cover. Keep nuts for use in the following steps. (See Figure 1.)
2. Install the 2-1/2" #10 screw (S-8570) through the flat washer (S-10106), clear PVC cover (AP-4700), nylon spacer (AP-4709) and flat washer (S-7112). Then insert the 2-1/2" screw through the top hole in the cover and loosely fasten with the existing nut.
3. Install the 2-1/2" #10 screw (S-8570) through the flat washer (S-10106), nylon spacer (AP-4709) and flat washer (S-7112). Then insert the 2-1/2" screw through the bottom hole in the cover and loosely fasten with the existing nut.
4. Rotate the cover so the notch in the clear PVC cover snaps onto the nylon spacer. Tighten nuts so the cover is firmly held in place, but is able to be rotated up for access to the control panel. (See Figure 2.)

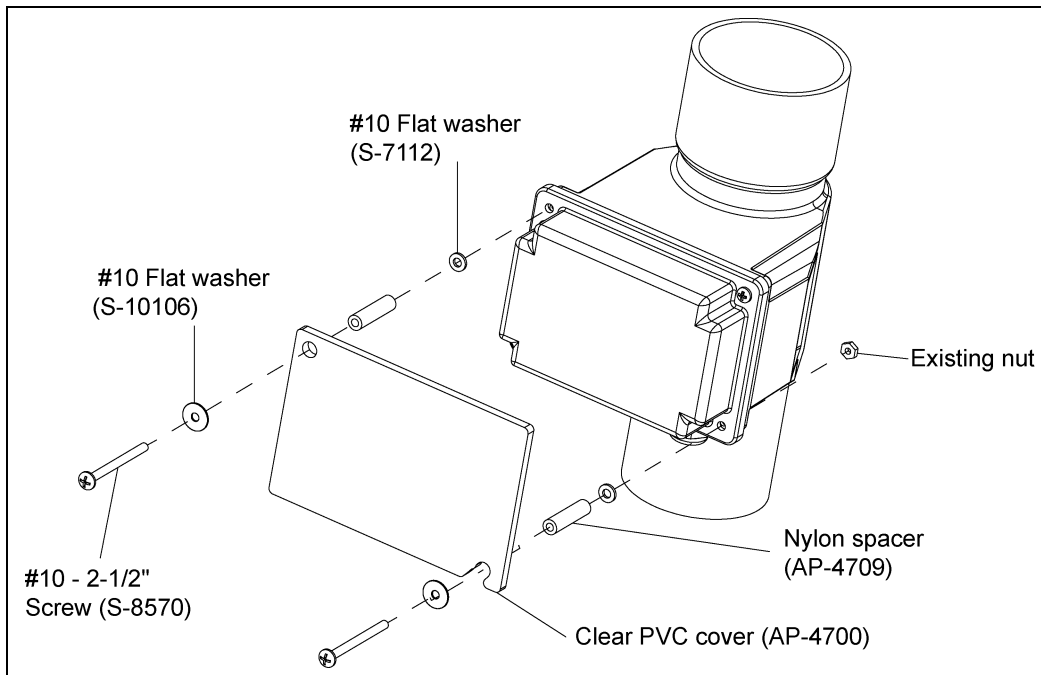

Figure 1

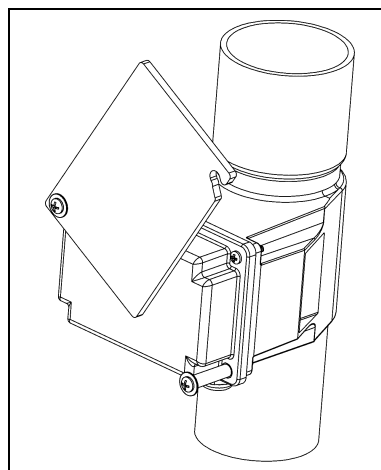

Figure 2

